

2-62 H

ORIGINAL INSTRUCTION MANUAL

GREENLINE

READ THIS INSTRUCTION MANUAL BEFORE USING THIS

SERIAL No:

.....(To be completed by user).....



MODEL DESCRIPTION

BVC GREENLINE 2/62 230V
BVC GREENLINE 2/62 110V

PART NUMBER

28 40151 03
28 40151 04

TABLE OF CONTENTS

Overview **02**

Safety, usage, guidelines & important notes

Safety **03**

Safety rules, Performance Details, Symbols & Signs

Parts Description & Assembly **04**

Vacuum Cleaner Parts List & Diagram

Operation **05**

Set up vacuum for use.

Maintenance **06**

Maintenance, Technical Check & PPE.

Technical Data & Spares **07**

Technical Data, Spares & Optional Accessories.

GREENLINE
1-33H & 1-33 HTC



VACUUM CLEANER USER MANUAL

This user-friendly guide is here to help you understand the essential functions and ensure a safe and effective cleaning experience.

OVERVIEW

This vacuum is designed to pick up dust and small deposits, suitable for various environments like hotels, schools, hospitals, factories, offices, and shops.

Please note that it is not suitable for liquid pick-up.

SAFETY & USAGE

The vacuum is built to handle high-hazard situations, effectively separating all types of dust while adhering to occupational exposure limits, including carcinogenic and pathogenic substances.

Operate the vacuum responsibly, and ensure proper use, maintenance, and repairs

GUIDELINES

If you encounter any issues, always consult your dealer for assistance.

Buyers must ensure informed individuals use the vacuum, and any modifications may void the warranty.

IMPORTANT NOTES

In case of a lost or damaged manual, contact the manufacturing company for a replacement.

If you sell the vacuum, provide the new owner with this manual or inform them about the manufacturing company's contact details.

SAFETY

Ensure safe and proper use of this device by following these essential guidelines

1.

This device is designed for dry suction only and should not be stored in open or damp conditions. Avoid directing the suction toward sensitive body parts of people or animals

2.

Be mindful of not exceeding the power limit if there's an additional plug to prevent potential hazards. Use only the specified brushes for safe operation.

3.

Always supervise the device during use, unplug it when not in use, and store it away from children or individuals unaware of its hazards.

4.

Avoid exhausting toxic, explosive, flammable, or excessively hot substances. Confirm comparability with electrical sockets and refrain from suctioning materials that could damage the filters.

5.

Never pull or lift the device by its cable, and regularly inspect the cable for damage or wear. Replace it if necessary to prevent accidents.

6.

Prioritise safety by wearing suitable gear and seal the filler when relocating the machine.

7.

Performance details:
PULSAR 515 H / ISSA
PULSAR 515 H: 1200 W
max - 22560 hPa.

8.



This symbol will be used to remind the operator to pay attention to operations that can cause injury or potential damage to the vacuum cleaner.

9.



(High Hazard) for separating all dusts with all limit values of occupational exposure including carcinogenic and pathogenic dusts.

PARTS DESCRIPTION AND ASSEMBLY

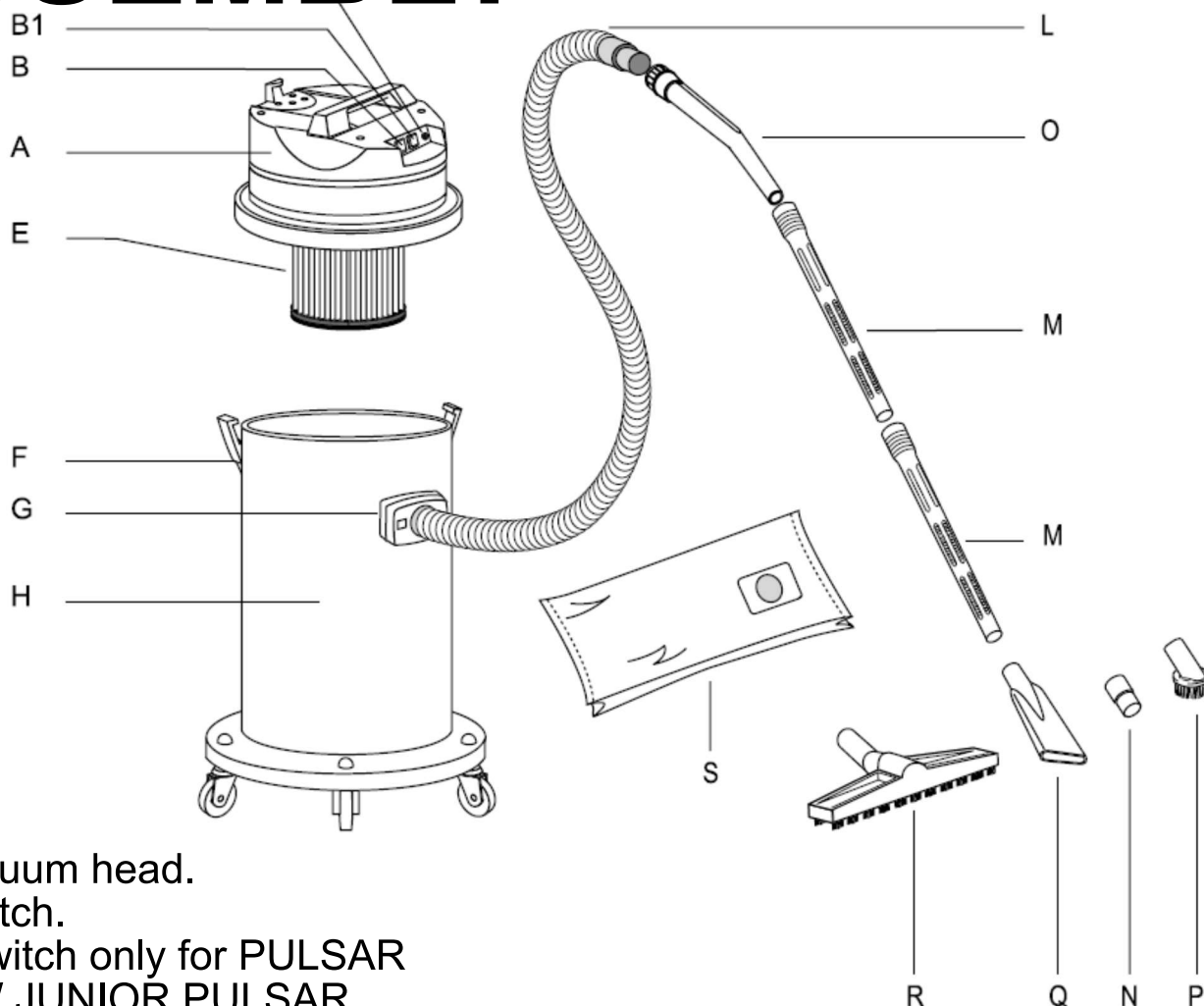

- A - Vacuum head.
- B - Switch.
- B1 - Switch only for PULSAR 429-H / JUNIOR PULSAR 429-H 2 motors
- B2 - Bag full Pilot light
- E - Filter cartridge
- F - Hooks for tightening of vacuum head to tank.
- G - Suction inlet.
- H - Tank.
- L - Flexible hose.
- M - Tube.
- N - Adaptor.
- O - Wand.
- P - Round brush.
- Q - Flat lance.
- R - Dust tool.
- S - Paper/cloth bag (OPTIONAL)



THE 6 STEPS OF OPERATION

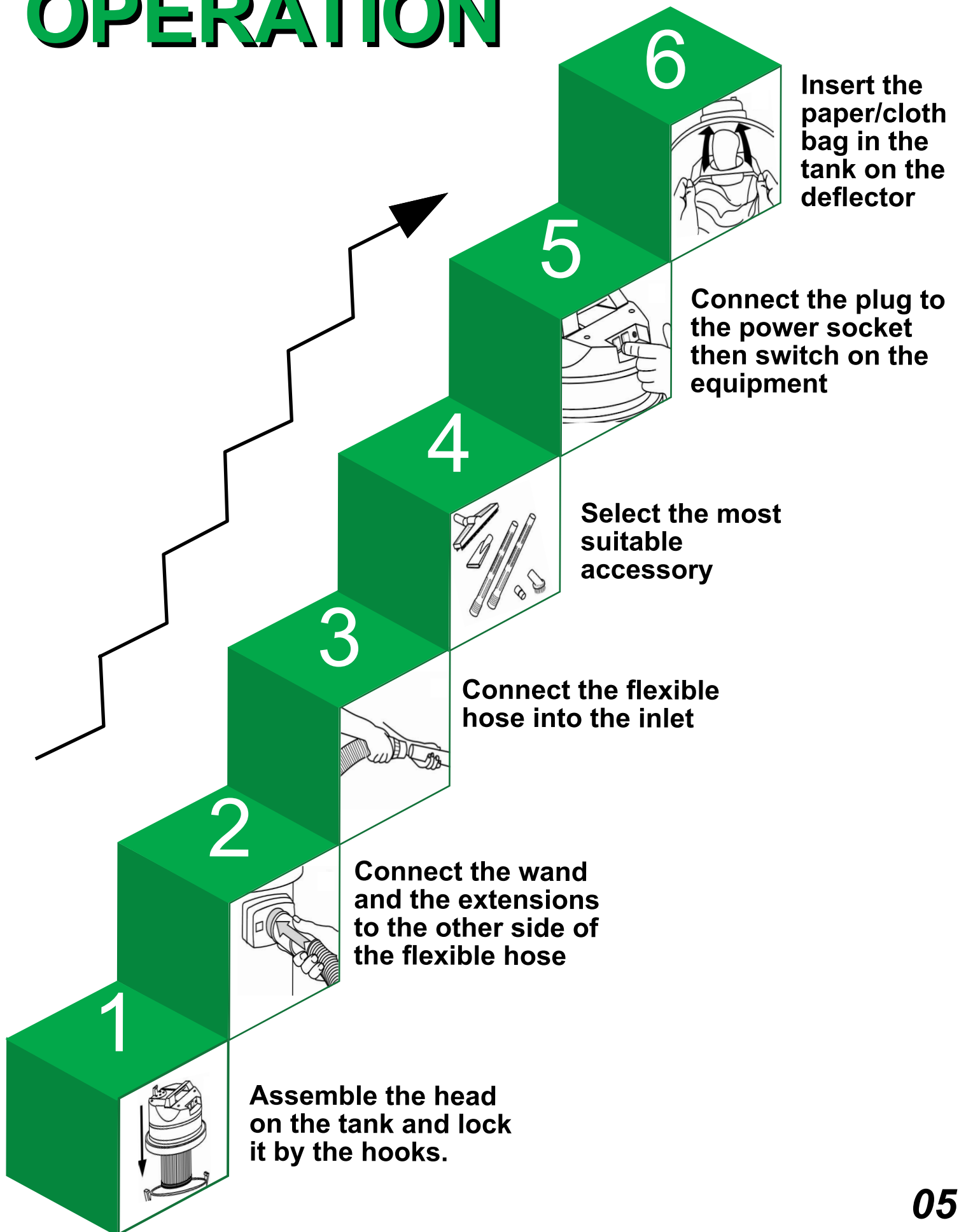

MAINTENANCE

For user maintenance, it's important to disassemble, clean, and service the device as needed, ensuring safety for maintenance staff and others. Precautions include decontamination before disassembly, forced air ventilation during the process, and proper cleaning of the maintenance area with staff protection.



TECHNICAL CHECK

A technical check, conducted by the user or a trained individual at least annually, involves examining filters, assessing the device's air-tightness, and verifying the control mechanism's functionality. During maintenance or repairs, any contaminated components unable to be adequately cleaned must be properly disposed of in impermeable bags, adhering to relevant regulations.

ITS IMPORTANT TO...

Verify the vacuum cleaner's condition for any bumps or damages.

Ensure the presence and effectiveness of all safety measures.

Conduct an annual check on the device's filtering efficiency.

THE DUST ON THE ABSOLUTE FILTER IS/ COULD BE TOXIC:

USE GLOVES



USE A CONTAINER SUITABLE FOR DISPOSAL



WEAR PROTECTIVE GLASSES



WEAR A FACE MASK



WEAR FULL OVERALL



TECHNICAL DATA

GS 2-62 H

Usage		DRY
Motor		2
Power	W	2000 - 2400 max
Voltage	V	220 - 240
Water Lift	mmH2O	2470
Airflow	m3/h	420
Tank Capacity/Material	l	62/steel
Cable Length	m	8,5
Filtering Surface	cm2	12,000
Sound Pressure level	dB[A]	74
Diameter of Accessories	mm	38
Dimensions	mm	550x600x960
Weight	kg	21,0

STANDARD EQUIPMENT

CODE: 281000007 HEPA CARTRIDGE UPSTREAM H14 12.000CM2	CODE: 281000013 DISPOSABLE PAPER BAG - CLASS M	CODE: RCVR00936 COMPLETE CAP FOR INLET (FOR SAFE DISPOSAL)
--	---	---



PMDT00565 - ONLY FOR GS 2/62 H - ACCESSORIES KIT Ø38 MM COMPOSED OF:

CODE: 280000080 FLEXIBLE HOSE 2,5m Ø38mm	CODE: 280063870 (FOR 1 PC) ALUMINIUM / PLASTIC TUBE 50cm Ø38mm (MACHINE COMES WITH 2PCS)	CODE: 280063890 HANDLE WITH AIR REGULATOR Ø38mm	CODE: 280063840 DUST TOOL Ø38mm	CODE: 280000030 FLAT LANCE Ø38mm	CODE: 280062950 ROUND BRUSH Ø38mm	CODE: 280063880 ADAPTER
---	---	--	---------------------------------------	--	---	----------------------------



PMDT01001 - ONLY FOR GS 2/62 H TC PN - ACCESSORIES KIT Ø36 MM COMPOSED OF:

CODE: TBFX01500 CONDUCTIVE FLEXIBLE HOSE 4m	CODE: TBBP00655 ELASTORAN HOSE 4,5m	CODE: MPVR85445 CLIP (CODES FOR 1 PC. MACHINE WITH 9 PC)	CODE: MPVR85407 PLASTIC TUBE 50cm (CODE FOR 1 PC. MACHINE COMES WITH 2 PC)	CODE: LAFN10880 CONDUCTIVE WAND WITH AIR REGULATOR
--	---	---	--	---



CODE: SPPV33288
DUST TOOL



CODE: 281006170
FLAT LANCE



CODE: 280000040
ROUND BRUSH



CODE: MPVR06998
TOOL ADAPTER



OPTIONAL ACCESSORIES

CODE: FTDP00567 MICROFIBER BAG CLASS M SET OF 5 PCS	CODE: MPVR11542 COVER FOR DRILL	CODE: PMDT00412 ELECTRO- PNEUMATIC KIT Ø29 mm	CODE: PMDT00411 ELECTRIC KIT Ø29 mm	CODE: PMDT00410 ELECTRO- PNEUMATIC KIT Ø36 MM
--	------------------------------------	--	---	--



X5



CODE: SPPV01771
DOUBLE USE BRUSH
36 mm



CODE: 281000007
HEPA CARTRIDGE
H14 BOX OF 2 PCS



X2

CODE: 281000007
HEPA CARTRIDGE
H14 BOX OF 3 PCS



X3

CODE: 281000007
HEPA CARTRIDGE
H14 BOX OF 8 PCS



X8